

PLAN
Scale 1:200

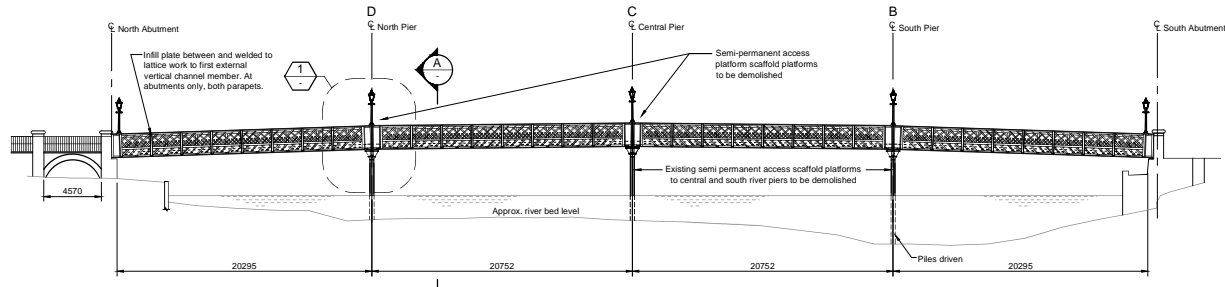

WEST ELEVATION
Scale 1:200
(Pier protectors not shown for clarity)



LOCATION PLAN

- NOTES:**
1. Do not scale.
 2. All dimensions are in millimetres unless noted otherwise.
 3. All levels are in metres AOD.
 4. All angles are in degrees.
 5. All co-ordinates are to ordnance survey.
 6. All proposed detail is indicative and liable to change in design.

Reproduced from the Ordnance Survey mapping with the permission of the Controller of Her Majesty's Stationery Office. © Crown Copyright. Unauthorised reproduction infringes Crown Copyright and may lead to prosecution or civil proceedings. Ordnance Survey Licence No. LA076866

Rev.	Date	Purpose of revision	Drawn	Checked	Approved
A	21/12/12	ORIGINAL ISSUE	EV	VR	BH
B	17/01/13	TENDER ISSUE	EV	VR	BH

The Company of Proprietors of Whitchurch Bridge



Project No: **WHITCHURCH BRIDGE RECONSTRUCTION**
OCC No. 148

Drawing No: **EXISTING GENERAL ARRANGEMENT**

Drawing Date: s6

Scale	Drawn by	Checked by	Approved by
G A1	EV	VR	BH
AS SHOWN	Date drawn: 21/12/12	Date checked: 21/12/12	Date approved: 21/12/12

Co-ordinate Project No & File No: **B148/5115284**

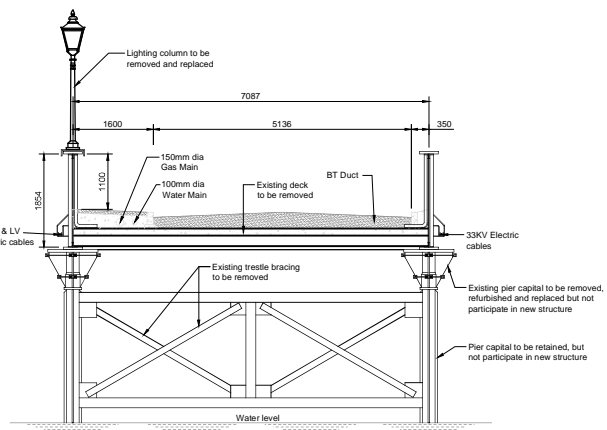

SECTION
Scale 1:50

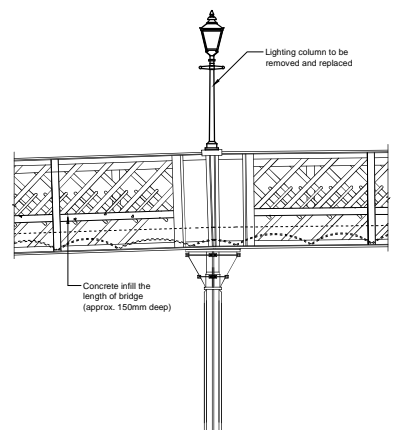

DETAIL
Scale 1:50
(Pier protectors not shown for clarity)

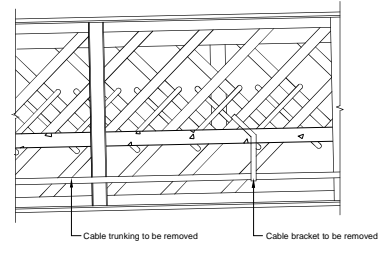

TYPICAL DETAIL OF LATTICE GIRDER
Scale 1:25
(showing verge concrete exposed and typical cable bracket)

Reproduction from the Ordnance Survey Map with the permission of the controller of Her Majesty's Stationery Office. Crown copyright. Ordnance Licence No. AL 100017026